

## Démarreur progressif

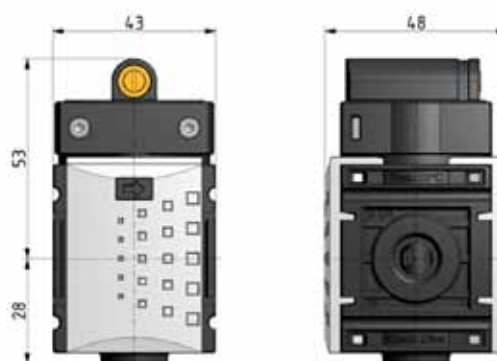

### Débit

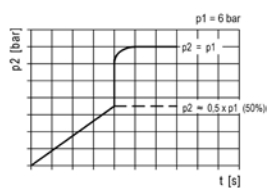

### Hystérésis

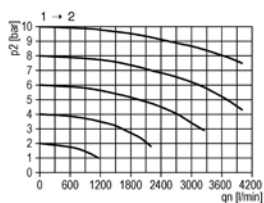

### Symbole

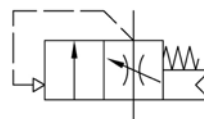

### Caractéristiques

- Description : lubrificateur
- Fluides : air comprimé, gaz neutres.
- Pression d'alimentation P1 : mini 2,5 bar
- Pression d'alimentation P1 : maxi 12 bar
- Température du fluide : 0 - 50°C
- Pression alternative : 50% P1 (uniquement pour les systèmes fermés)

### Accessoires



Kit de fixation murale  
BW-0



Kit de fixation murale  
KOP-OW

### type

KSSV-014

### description

Démarreur progressif G1/4



# Série modulaire FUTURA | Démarrage progressif réglable - Taille 1

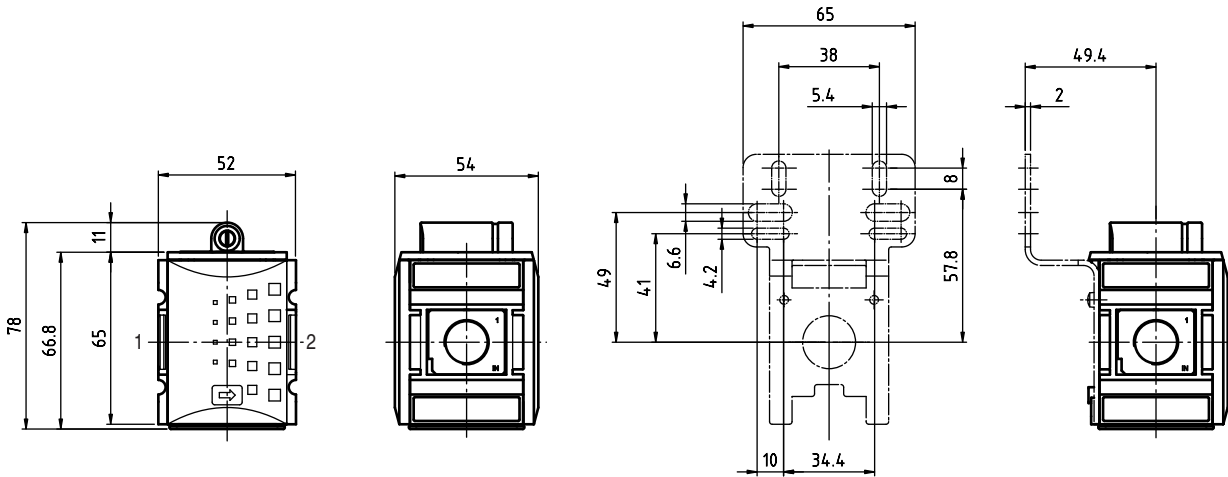

## Courbes de débit

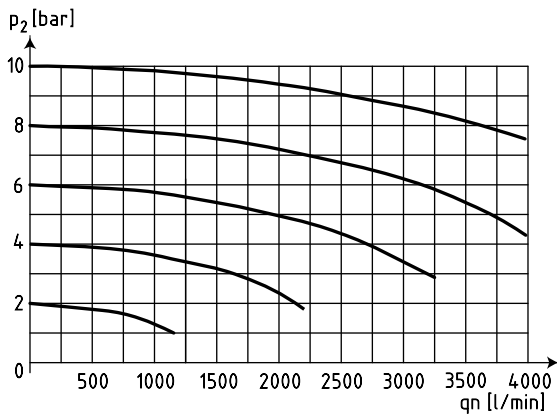

## Accessoires

Jeu d'assemblage

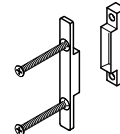

Type: KOP.1W

Équerre de fixation  
(vis incluses)

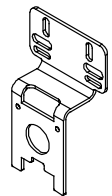

Type: BW.1

Jeu d'assemblage  
montage mural

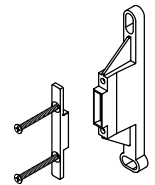

Type: KOP.114K



# Série modulaire FUTURA | Démarrage progressif réglable - Taille 2

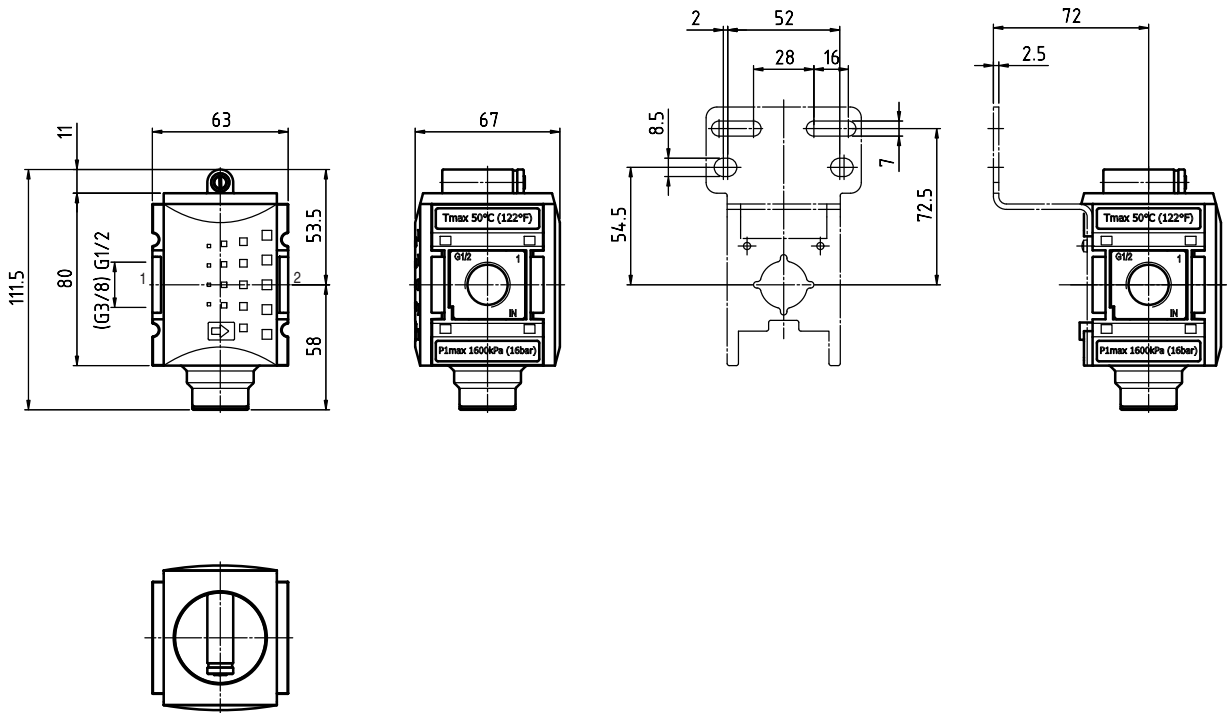

## Courbes de débit

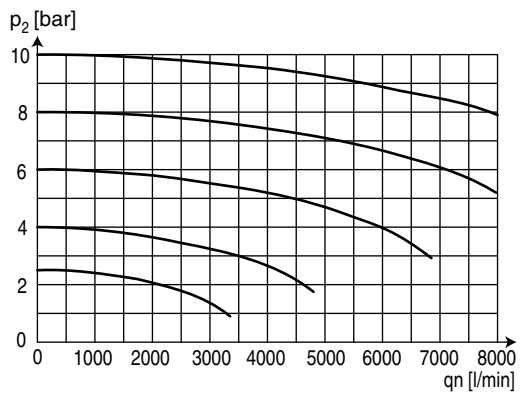

## Accessoires

Jeu d'assemblage

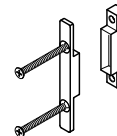

Type: KOP.2

Équerre de fixation (vis incluses)

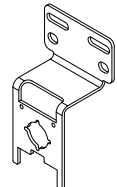

Type: BW.2

Jeu d'assemblage montage mural

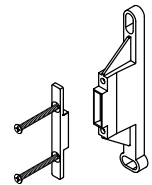

Type: KOP.2K



# Série modulaire FUTURA | Démarrage progressif réglable - Taille 4

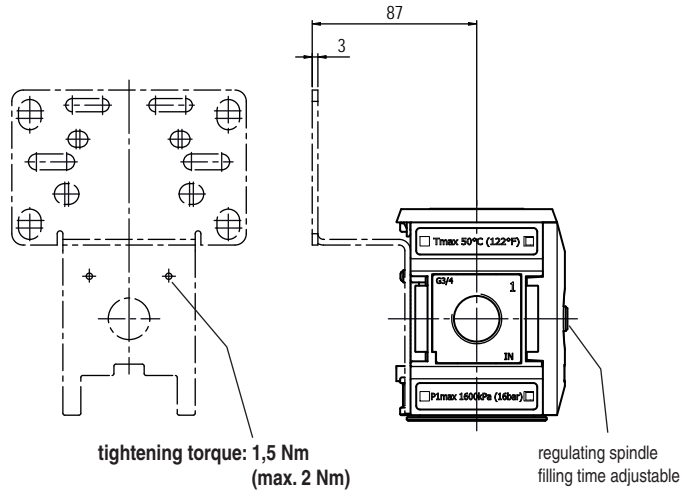
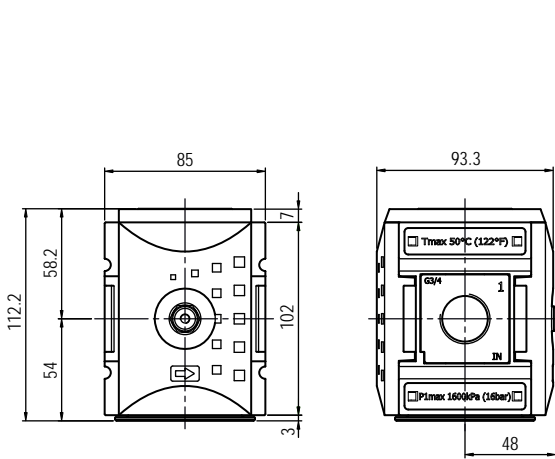

## Courbes de débit

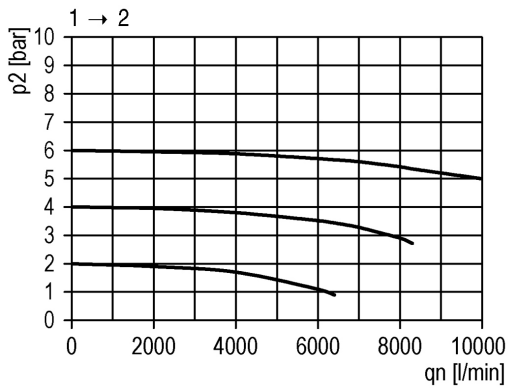

## Caractéristique de remplissage

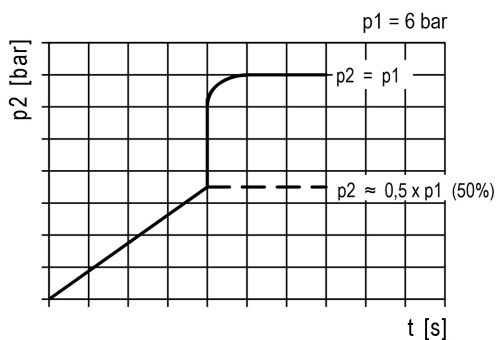

## Accessoires

